

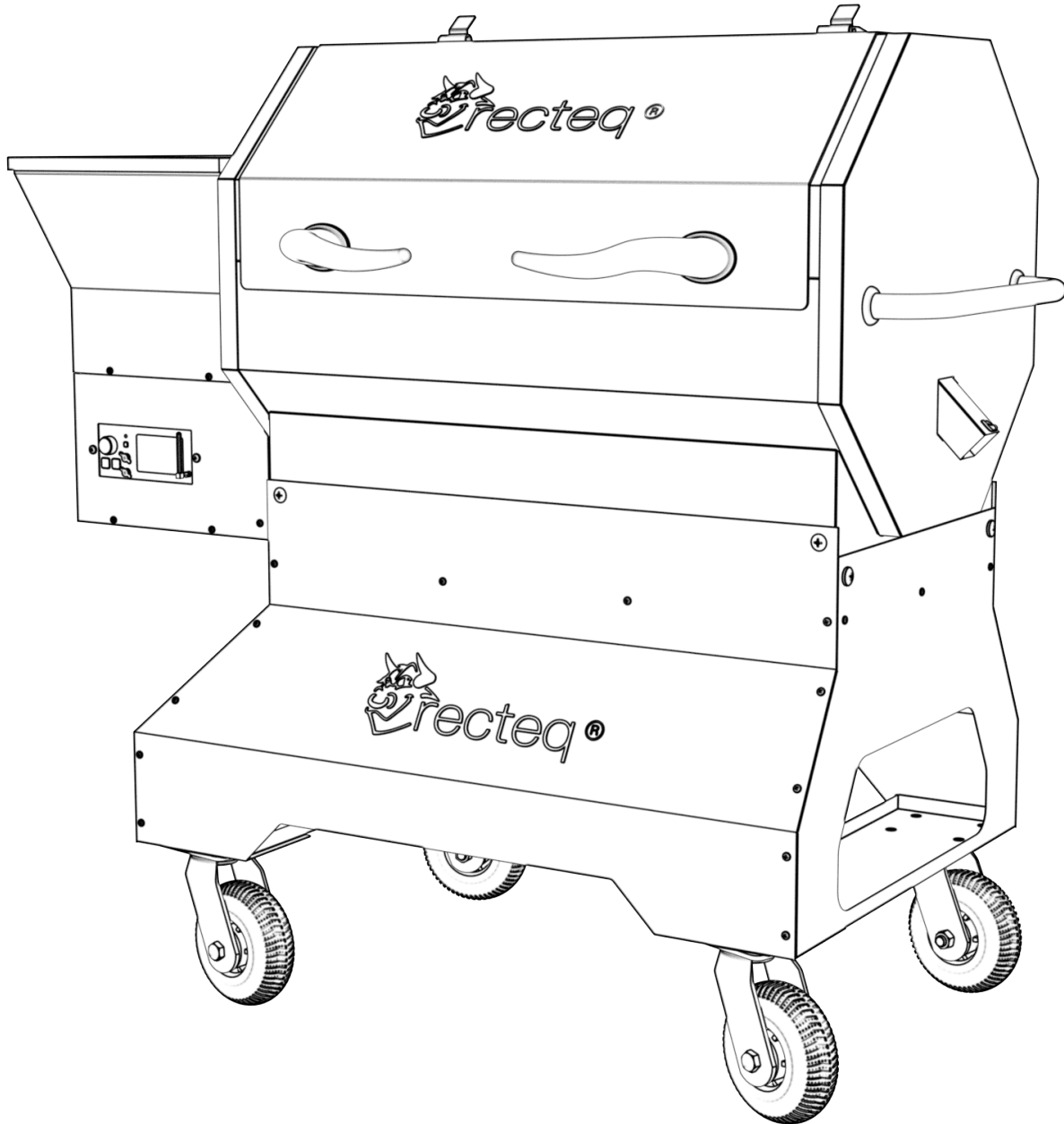

RT-590 Competition Cart



— Assembly Manual —

RT-590

Competition Cart Assembly

Step 1: Unpack and prepare for assembly.

Step 2: Attach right side panel to front panel.

Step 3: Attach left side panel to front panel.

Step 4: Attach back panel onto the rest of the assembly.

Step 5: Slide internal cart frame and attach to cart assembly.

Use provided black machine screws for steps 2-5.

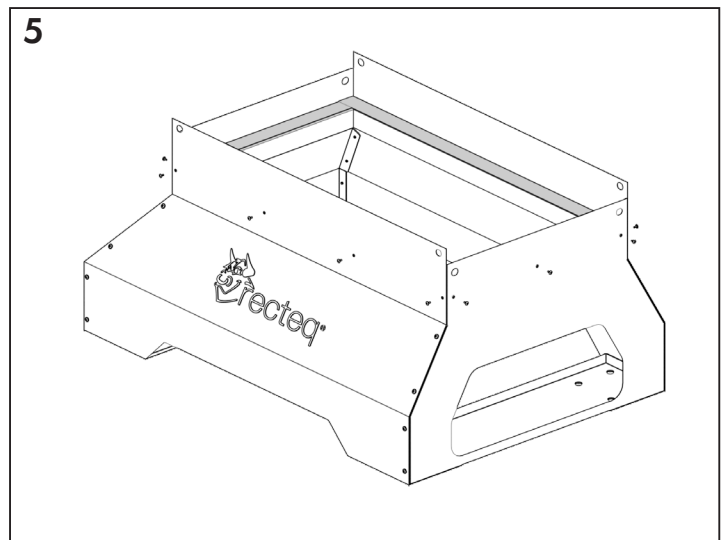
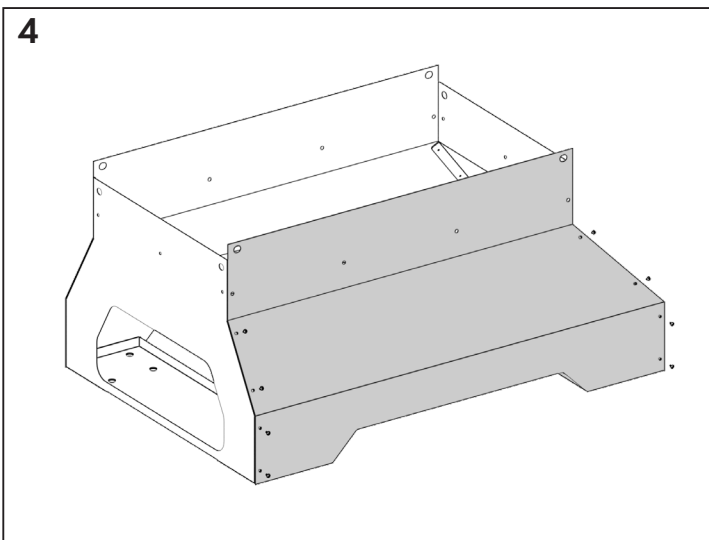
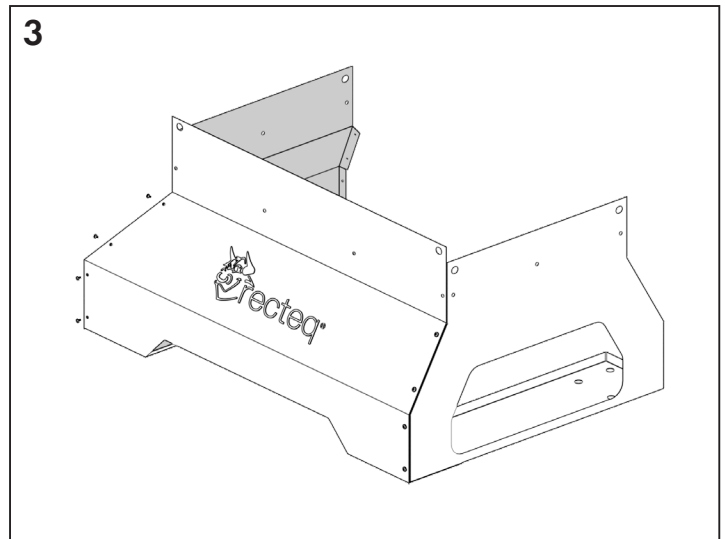
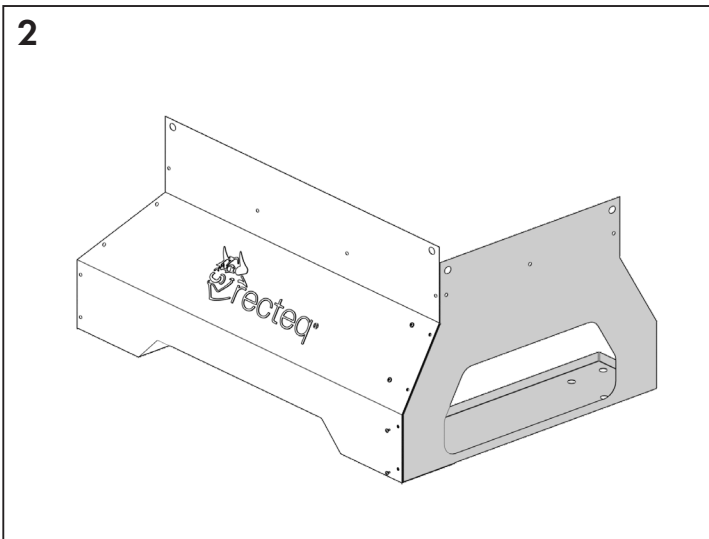

RT-590

Competition Cart Assembly cont.

Step 6: *With assistance*, flip cart over to attach wheels.

Step 7: Attach locking caster wheels following bolt assembly order.

Step 8: *Lock caster wheels* and flip cart over with assistance.

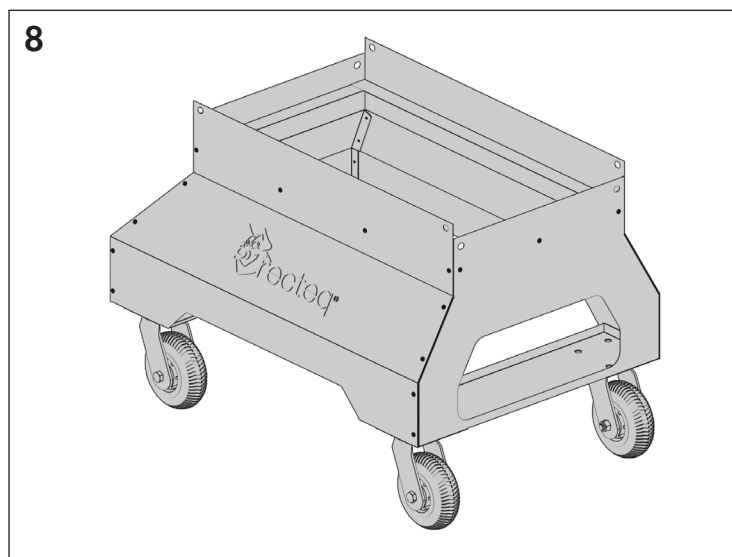
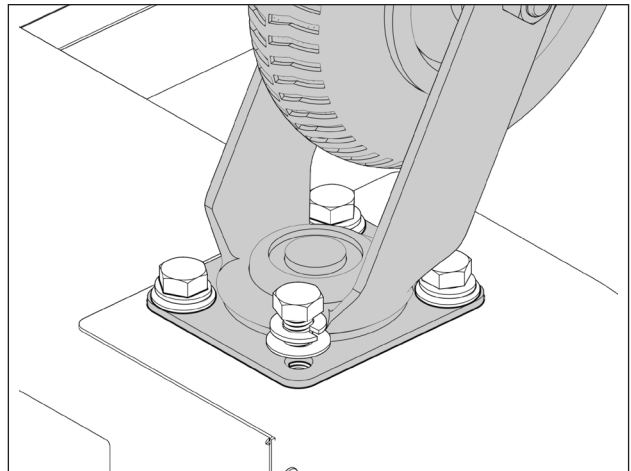
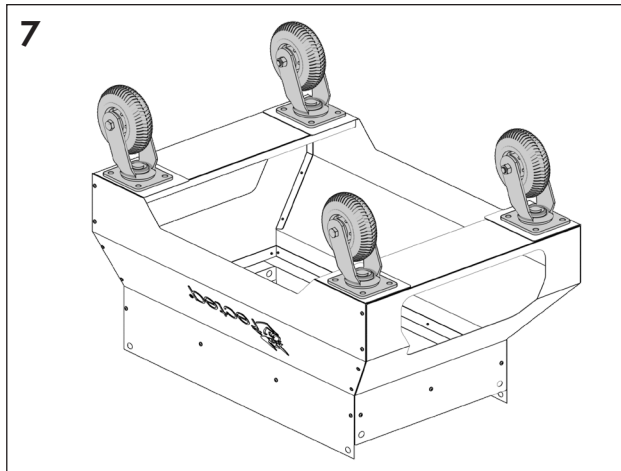
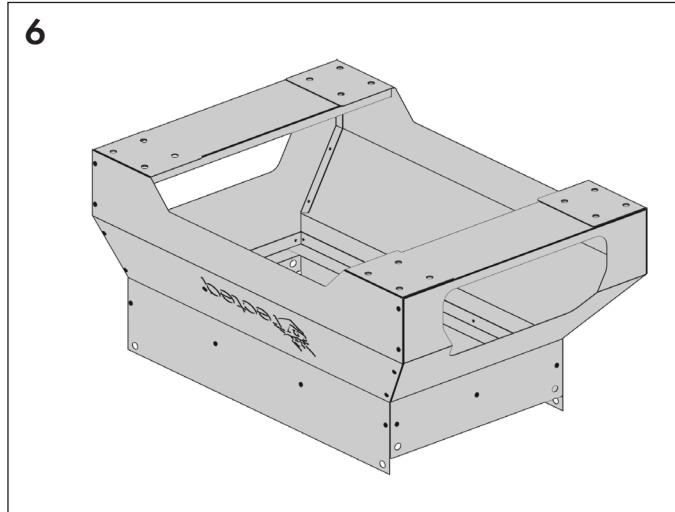

RT-590

Competition Cart Assembly cont.

Step 9: *With assistance, lift grill onto cart.*

Step 10: Use long stainless steel bolts to attach cart to the grill.

For front shelf: Thread bolt through front shelf, cart, then grill.

